



585 E. South Frontage Rd., Bolingbrook, IL 60440 1-800-739-4430 • www.fischercrane.com • sales@fischercrane.com



Amco Veba 810 - 10 tm available with up to 5 hydraulic extensions



REACH @ CAPACITY

Configuration	Lbs	ft'in"	Lbs	ft'in"	Lbs	ft'in"	Lbs	ft'in"	Lbs	ft'in"	Lbs	ft'in"		
1S	9480	7'3"	5030	13'9"	3510	19'6"								
2S	9040	7'3"	4810	13'9"	3310	19'6"	2490	25'5"	*1790	*31'10"	*1300	*38'9"	*960	*45'7"
3S	8770	7'3"	4520	14'1"	3020	19'10"	2250	25'9"	1790	31'10"	*1300	*38'9"	*960	*45'7"
4S	8470	7'3"	4250	14'5"	2820	20'2"	2050	26'1"	1600	32'2"	1300	38'9"	*960	*45'7"
5S	8160	7'3"	4010	14'8"	2620	20'6"	1870	26'5"	1420	32'6"	1150	38'7"	960	45'1"

* Manually extendable extension optional

SPECIFICATIONS	1S	2S	3S	4S	5S
Number of Extensions	1-Hydraulic	2-Hydraulic	3-Hydraulic	4-Hydraulic	5-Hydraulic
Crane Rating (ft. lbs.)	68,400 (10 tm)	68,400 (10 tm)	68,400 (10 tm)	68,400 (10 tm)	68,400 (10 tm)
Max. Horizontal Reach - hydraulic	19'6"	25'5"	31'10"	38'9"	45'1"
Max. Vertical Reach - hydraulic	27'11"	33'6"	38'5"	43'8"	50'0"
Max. Capacity (lbs.)	3510	2490	1790	1300	960
Crane Weight (lbs.)	2710	2940	3150	3350	3510
Crane Dimensions	98"x86"x26"	98"x86"x26"	98"x86"x26"	98"x86"x26"	98"x86"x26"
Mounting Space	7'7"x2'6"x7'2"	7'7"x2'6"x7'2"	7'7"x2'6"x7'2"	7'7"x2'6"x7'2"	7'7"x2'6"x7'2"
Slewing Angle (degrees)	395	395	395	395	395
Oil Tank Capacity (gallons)	15	15	15	15	15
Max. Oil Flow (gpm)	6.6	6.6	6.6	6.6	6.6
Max. Working Pressure (psi)	4206	4206	4206	4206	4206
Outrigger Extention	11'11"	11'11"	11'11"	11'11"	11'11"

STANDARD FEATURES

- Dual side controls - except with remote
- Hexagonal extension cylinders
- Sliding pads on telescopic extensions
- Flanged Valves
- Self lubricating bushings
- Oil tank
- Din and JIC fittings
- Designed in accordance with EN 12999
- Fatigue test classifications: B3
- Rack and pinion rotation
- Manually extendable stabilizers
- One year warranty

ACCESSORIES

- RRS radio remote
- Manual extensions
- Optional load limiting device
- Extra function to boom tip
- Extra valve function for winch
- Winch
- Pressure gauge
- Gear pump
- Winch plate
- Turning stabilizers
- Extra side extension of stabilizers
- Stabilizers with hydraulic extensions

DIMENSIONS

810 5S

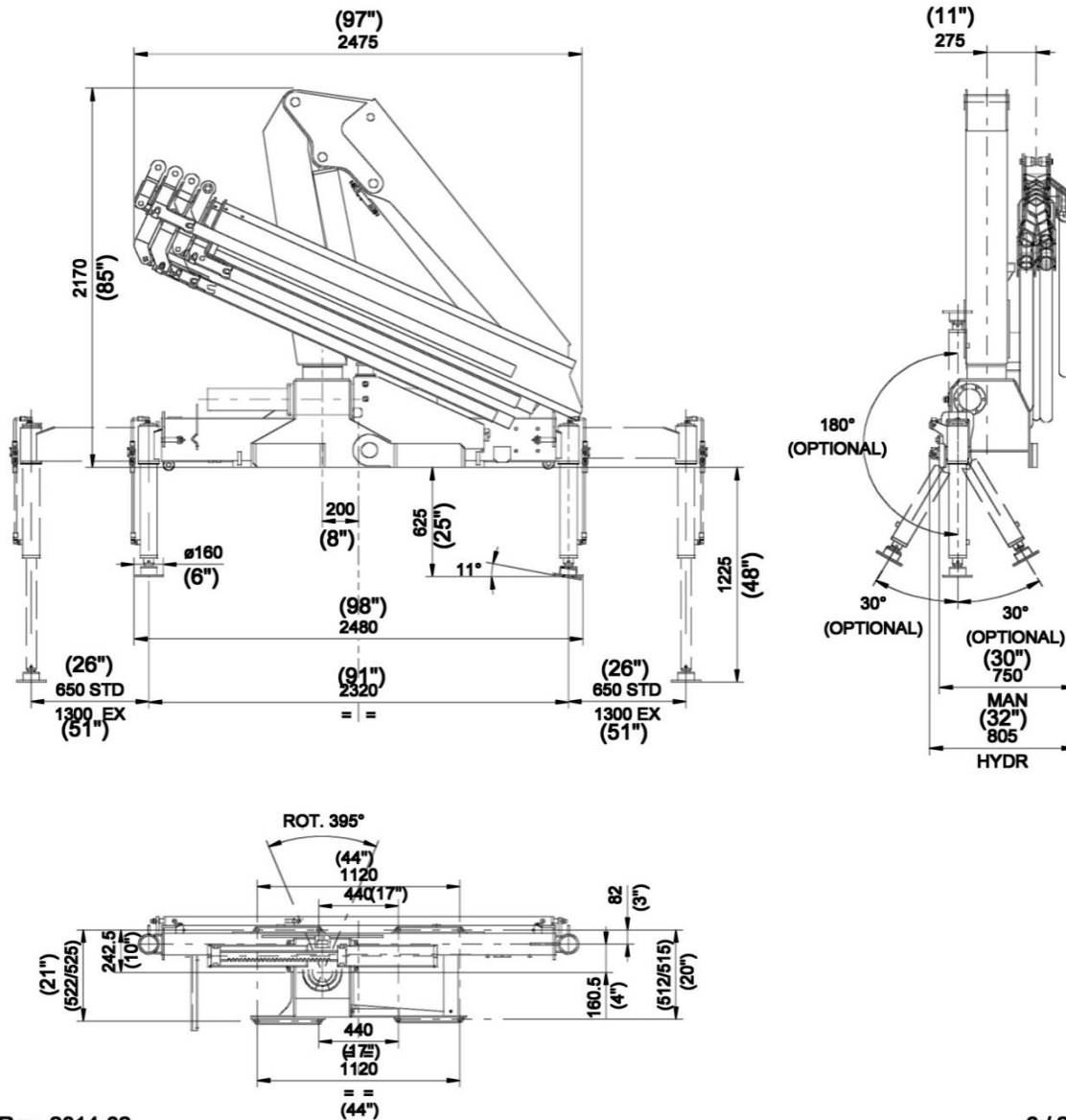

Rev. 2014-02

6 / 24

SPECIAL FEATURES

**907N Model Includes*

**Only with CE or Radio Remote*



Radio Remote Control

The operator can control the crane with high precision proportional levers in every position, and in doing so, can supervise the loading and unloading operations. That means a time savings and greater safety. The operator can also control the truck engine start, stop and accelerator with the remote control. All of the remote controls used by AMCO VEBA have an identification code and are shielded from electro-magnetic fields and from external radio signals.



Electronic Black Box

Amco Veba has designed this control motherboard to ensure an effective and reliable control of the crane in every working condition. The operator can read on the display all the information about the state of the crane, of the accessories, and of the routine maintenance. All components are designed according to automotive industry standards and ensure the highest reliability.



Sprint Generation System

The purpose of SGS system is to increase the extensions speed without affecting the crane safety.